



## Fitting Guide for AirFit P10



1 • Hold the pillows at your nose, ensuring that the pillow size indicator is on the bottom and you can see the left (L) and right (R) orientation indicators.



2 • Stretch the lower strap around the back of your head.  
• The top strap should sit comfortably on top of your head.



3 • Pull the headgear over your head by holding the lower strap.

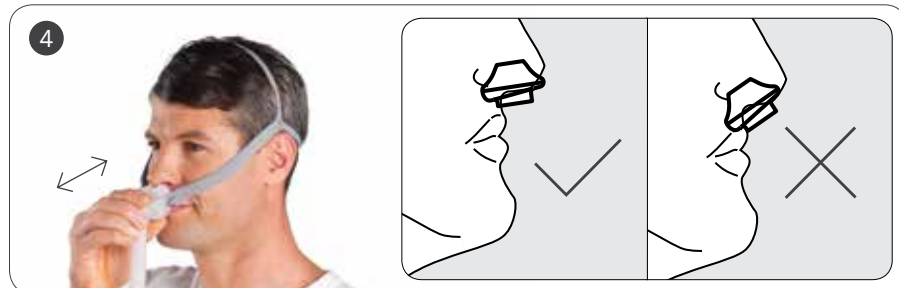

4 • Move the mask away from your face, and then place it back again.  
• Ensure the nasal pillows fit securely into your nostrils with both pillows positioned upright.



5 • Finally, connect the end of the mask's tube into your device's air tubing.  
• Turn on your device — your mask is now ready to use.



• If adjustment is needed, simply spread the upper and lower straps apart to loosen, or draw them closer together to tighten.

**Note:** For complete user instructions, refer to the AirFit P10 User Guide.

**DISTRIBUTED BY**  
ResMed Corp, 9001 Spectrum Center Boulevard, San Diego, CA 92123 USA

ResMed Corp San Diego, CA, USA +1 858 836 5000 or 1 800 424 0737 (toll free). ResMed Ltd Bella Vista, NSW, Australia +61 (2) 8884 1000 or 1 800 658 189 (toll free). See ResMed.com for other ResMed locations worldwide. AirFit, QuickFit and QuietAir are trademarks of ResMed Ltd. Swift is a trademark of ResMed Ltd and is registered in the U.S. Patent and Trademark Office. ©2013 ResMed. Specifications may change without notice. 1016801/1 2013-10

ResMed.com



## AirFit™ P10... a quieter mask to fit your sleep.

The ResMed AirFit™ P10 nasal pillows mask delivers the premium performance and reliability of the Swift™ FX mask, yet it's approximately 50% lighter and 50% quieter.<sup>1</sup> A recent study found that patients slept more than 40 minutes longer per night using the AirFit P10 compared to the leading nasal pillows mask.<sup>2</sup>



### Benefits for you ...

**Supports patient acceptance** thanks to ease of use, lighter weight and greater comfort.

**QuickFit™ auto-adjusting headgear** can be fitted in 30 seconds or less.<sup>3</sup>

**Simple sizing and color-coded pillows** make fitting easier, encouraging patient compliance.

### ... and your patients

**QuietAir™ woven-mesh vent** makes this ResMed's quietest mask at just 21.4 dBA.\*<sup>2</sup>

**Minimal design and light weight (1.6 oz)** deliver a high level of comfort and facial freedom.

**Just three parts** — frame, cushion and headgear — make it easy to assemble and take apart for cleaning.

\* Declared dual numbered noise emission values (with uncertainty 3dBA) in accordance with ISO 4871.

<sup>1</sup> ResMed Ref: D000-0201; eLB0798-206.

<sup>2</sup> ResMed Clinical Study FECS3 Ref: D629-117 (page 11). ResMed objective data (pressure, leak, usage, AHI).

<sup>3</sup> ResMed Clinical Study FECS3 Ref: D629-117 (page 9). 90% of participants fitted the mask comfortably in less than 30 seconds.



### Comfort with stability.

A recent clinical study found that more than 70% of patients preferred the new ResMed AirFit P10 to the popular Swift FX mask for both comfort and stability. On average, participants also slept more than 40 minutes longer per night using AirFit P10 compared to the leading nasal pillows mask.<sup>2</sup>

The AirFit P10 nasal pillows mask provides a stable seal and a high level of comfort, with excellent usability. It also provides patients with a real sense of facial freedom. The mask's innovative QuickFit elastic headgear is unobtrusive yet provides a two-point head support with minimal facial contact—designed to encourage easy patient acceptance.



**Flexible pillows**  
with trampoline action.

**Dual-wall nasal pillows**  
seal on contact and offer a wide range of sizes.

**Color-coded cushions**  
for easy identification.

**Three-part simplicity**  
for fast and easy assembly.

**Lightweight integrated flexi-tube**  
allows for flexibility without sacrificing stability.

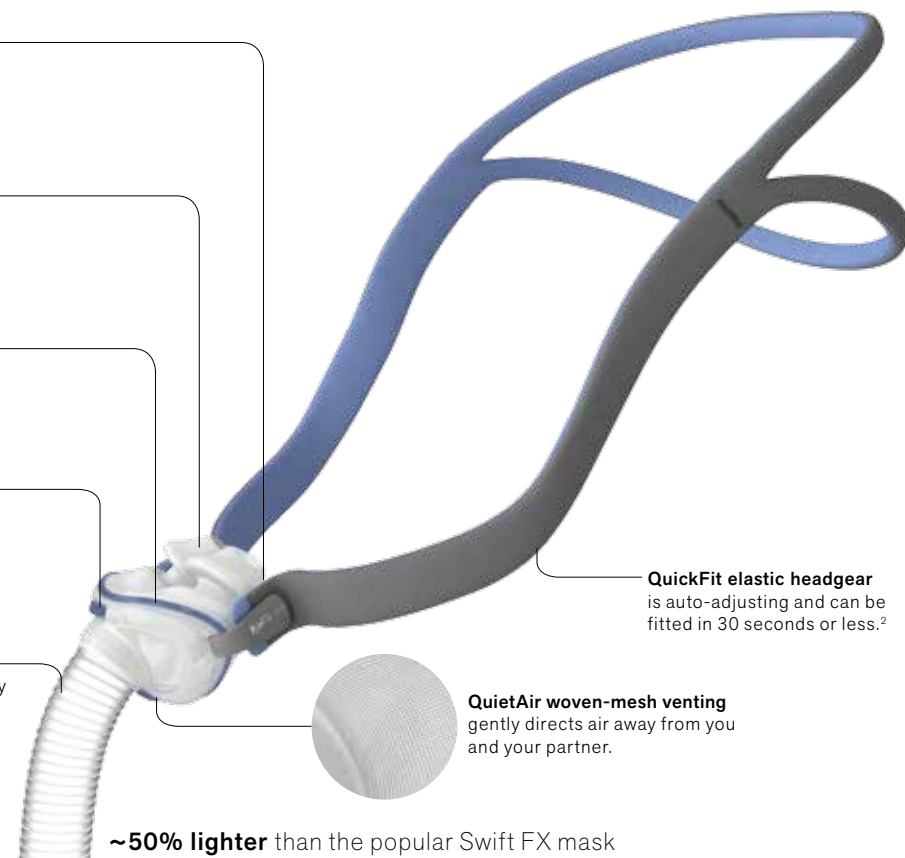

**QuickFit elastic headgear**  
is auto-adjusting and can be fitted in 30 seconds or less.<sup>2</sup>

**QuietAir woven-mesh venting**  
gently directs air away from you and your partner.

~50% lighter than the popular Swift FX mask

### Components Card for AirFit P10

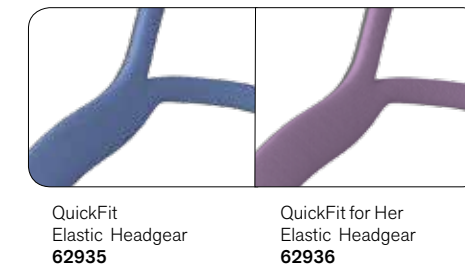

**Frame system**  
62920 (XS)  
62921 (S)  
62922 (M)  
62923 (L)

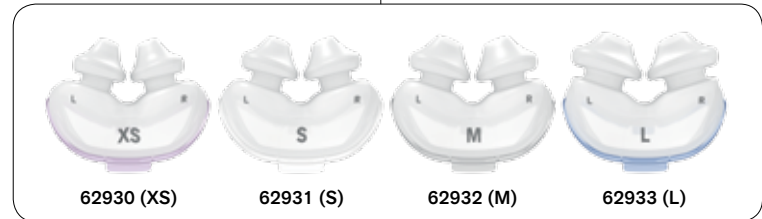
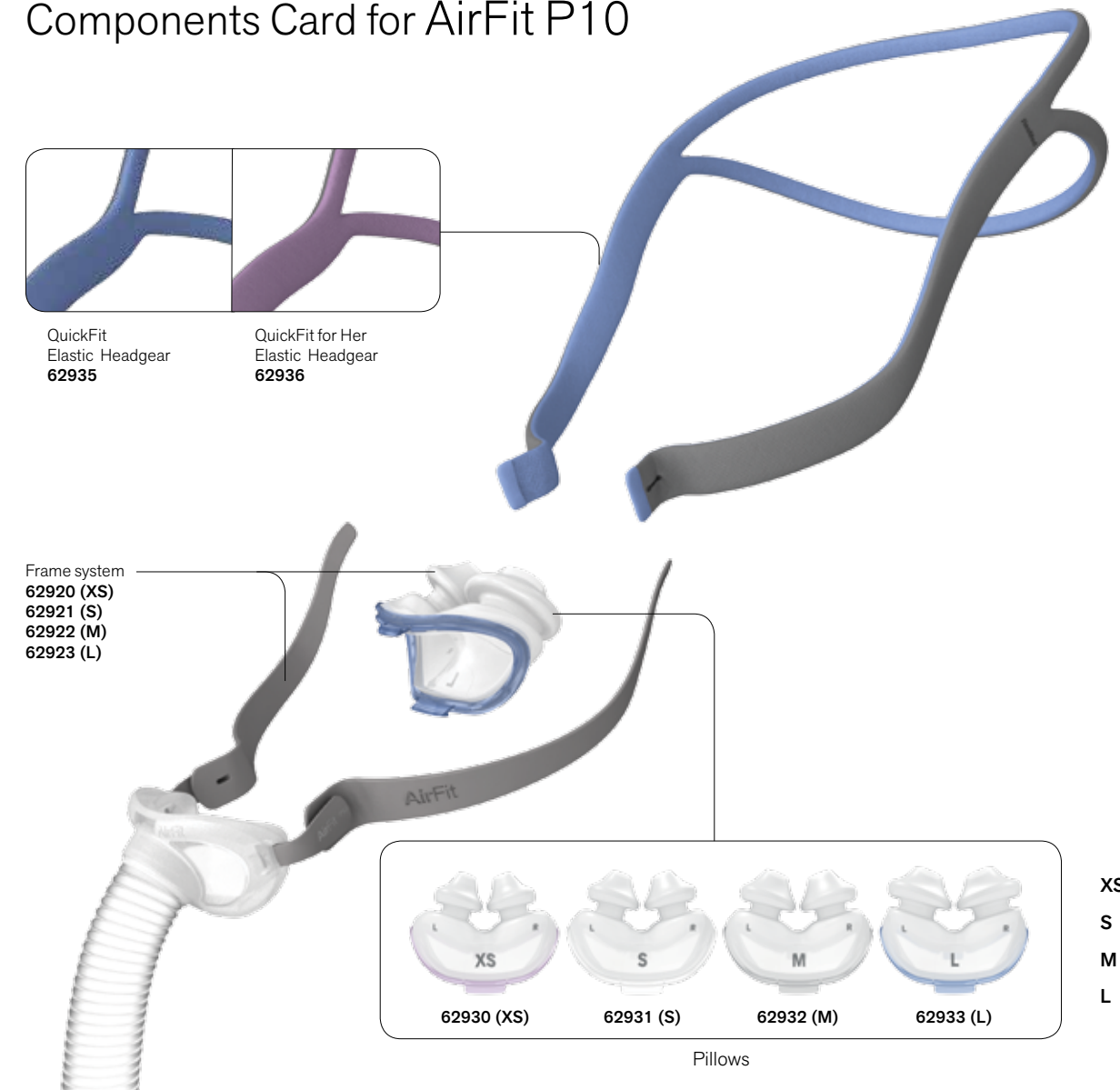

**XS** Extra Small  
**S** Small  
**M** Medium  
**L** Large

### Product Codes

**62900** AirFit P10 – complete system<sup>\*</sup>  
**62910** AirFit P10 for Her – complete system<sup>\*\*</sup>

<sup>\*</sup> S, M and L pillows come packaged with the mask.  
<sup>\*\*</sup> XS, S and M pillows come packaged with the mask.

**Note:** For details, refer to the AirFit P10 User Guide.