

RESMED



Click Here To Buy

Mirage Swift™ II

NASAL PILLOWS SYSTEM

User Guide

English

Log on now to www.myresmed.com
to find useful tips on managing your treatment.



Mirage Swift™ II

NASAL PILLOWS SYSTEM

Illustrations Sheet / Fiche d'illustrations / Hoja de Figuras / Folheto de Ilustrações

Note: For complete instructions, read the text section in conjunction with the illustrations on this sheet.

Remarque : pour les instructions complètes, veuillez lire le texte du guide avec cette fiche d'illustrations.

Nota: Para tener instrucciones completas, lea el texto en conjunto con las figuras de esta hoja.

Nota: Para obter as instruções completas, leia a secção de texto em conjugação com as ilustrações deste folheto.

A

Parts of the Mirage Swift™ II / Composants du Mirage Swift™ II / Partes del Mirage Swift™ II / Componentes do Mirage Swift™ II

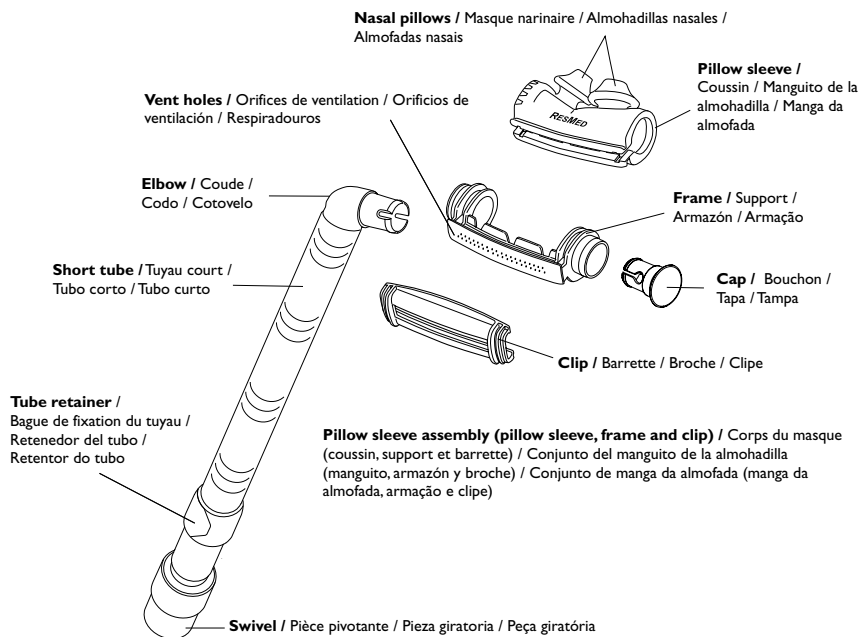

Short tube assembly (elbow, short tube and swivel) / Ensemble tuyau court (coude, tuyau court et pièce pivotante) / Conjunto del tubo corto (codo, tubo corto y pieza giratoria) / Conjunto de tubo curto (cotovelo, tubo curto e peça giratória)

Headgear / Harnais / Arnés para la cabeza / Arnês

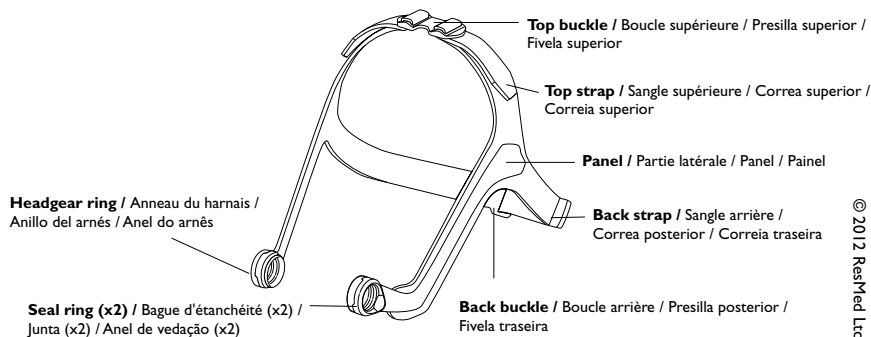

B

Fitting the Mirage Swift II / Mise en place du masque narinaire Mirage Swift II / Colocación del sistema Mirage Swift II / Colocação da Mirage Swift II

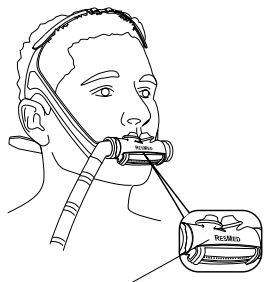
1

ResMed logo faces outward / Logo ResMed tourné vers l'extérieur / El logotipo de ResMed se dirige hacia afuera / O logotipo da ResMed está virado para fora

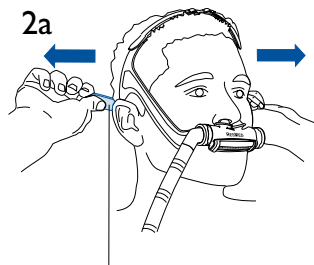
2a

Adjust back straps / Ajustez les sangles arrières / Ajuste las correas posteriores / Ajuste as correias traseiras

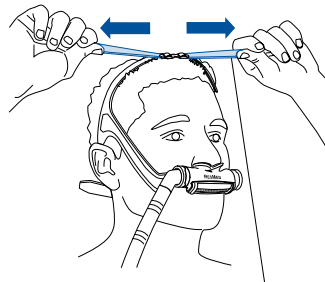
2b

Adjust top straps / Ajustez les sangles supérieures / Ajuste las correas superiores / Ajuste as correias superiores

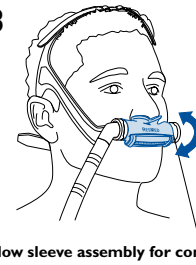
3

Rotate pillow sleeve assembly for comfort and seal / Faites pivoter le corps du masque pour obtenir un ajustement confortable et une étanchéité efficace / Rote el conjunto del manguito de la almohadilla para un ajuste cómodo y sin fugas / Gire o conjunto de manga da almofada para uma melhor vedação e maior conforto

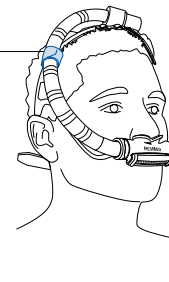
4

Tube retainer (optional) / Bague de fixation du tuyau (facultative) / Retenedor del tubo (opcional) / Retenedor do tubo (opcional)

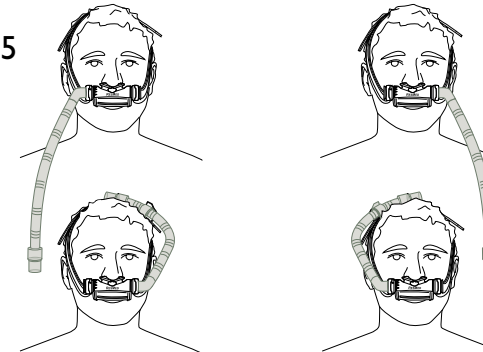
5

Optional tube positions / Positions possibles pour le tuyau / Posiciones posibles del tubo / Posições opcionais do tubo

© 2012 ResMed Ltd.

C

Disassembling for Cleaning / Démontage pour le nettoyage / Desmontaje para la limpieza / Desmontagem para limpeza

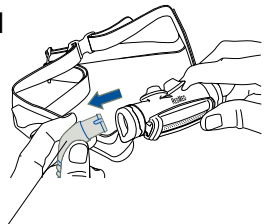
1

Elbow / Coude / Codo / Cotovelo

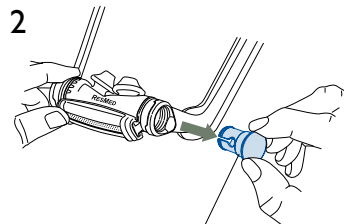
2

Cap / Bouchon / Tapa / Tampa

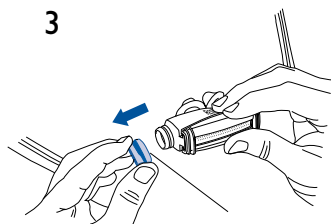
3

Headgear ring / Anneau du harnais / Anillo del arnés / Anel do arnés

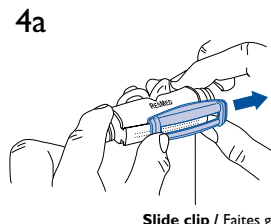
4a

Slide clip / Faites glisser la barrette / Deslice el broche / Deslice o clipe

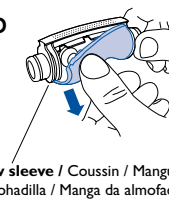
4b

Pillow sleeve / Coussin / Manguito de la almohadilla / Manga da almofada

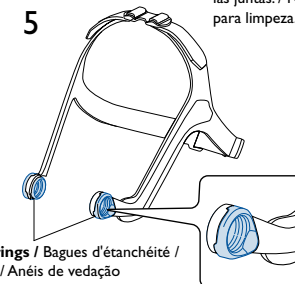
5

Seal rings / Bagues d'étanchéité / Juntas / Anéis de vedação

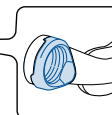

Note: The seal rings do not need to be removed for cleaning. / Remarque : vous n'avez pas besoin de retirer les bagues d'étanchéité du harnais pour le nettoyage. / Nota: Para la limpieza no es necesario retirar las juntas. / Nota: Os anéis de vedação não necessitam de ser removidos para limpeza.

© 2012 ResMed Ltd.

D

Reassembling the Mirage Swift II / Remontage du masque narinaire Mirage Swift II / Montaje del sistema Mirage Swift II / Como voltar a montar a Mirage Swift II

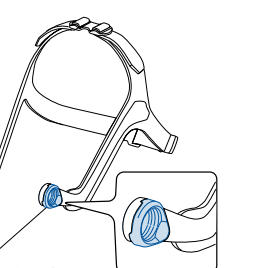
1

Seal rings / Bagues d'étanchéité / Juntas / Anéis de vedação

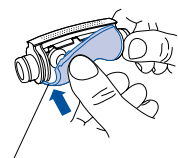
2a

Pillow sleeve / Coussin / Manguito de la almohadilla / Manga da almofada

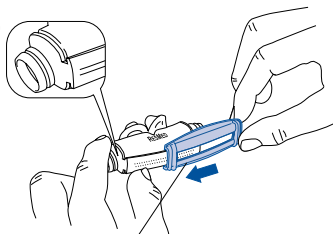
2b

Slide clip / Faites glisser la barrette / Deslice el broche / Deslice o clipe

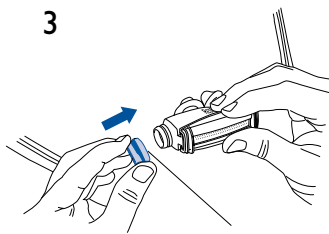
3

Headgear ring / Anneau du harnais / Anillo del arnés / Anel do arnés

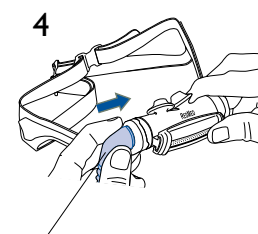
4

Elbow / Coude / Codo / Cotovelo

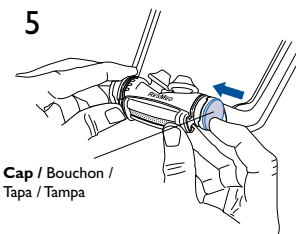
5

Cap / Bouchon / Tapa / Tampa

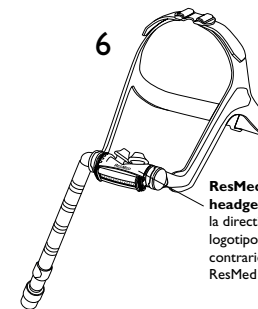
6

ResMed logo faces away from headgear / Logo ResMed tourné dans la direction opposée au harnais / El logotipo de ResMed queda en sentido contrario al arnés / O logotipo da ResMed está virado para fora do arnés

© 2012 ResMed Ltd.

Note: The headgear does not need to be taken apart for cleaning. Headgear reassembly instructions are provided here as additional information. / **Remarque :** il n'est pas nécessaire de démonter le harnais pour le nettoyage. Les instructions de remontage sont fournies à titre indicatif. / **Nota:** El arnés no necesita ser desmontado para su limpieza. Las instrucciones para el montaje del arnés se proporcionan únicamente como información adicional. / **Nota:** Não necessita de desmontar o arnés antes de proceder à limpeza. As instruções de montagem do arnés são oferecidas como informações adicionais.

E

Reassembling the Headgear / Remontage du harnais / Montaje del arnés / Como voltar a montar o arnés

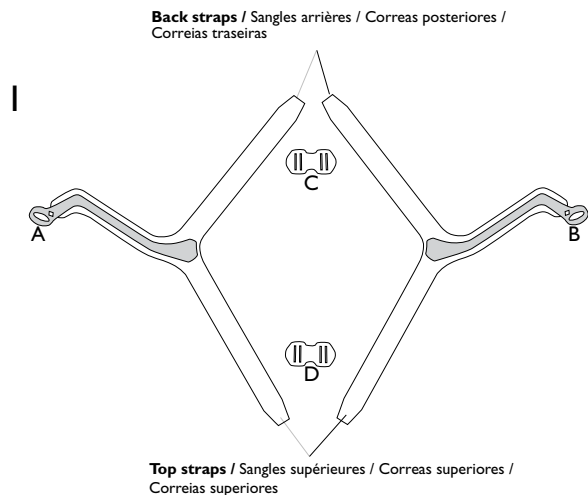

2a **Back buckle / Boucle arrière / Presilla posterior / Fivela traseira**

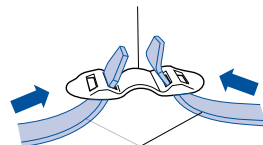

Back straps / Sangles arrières / Correas posteriores / Correas traseiras

3a **Top buckle / Boucle supérieure / Presilla superior / Fivela superior**

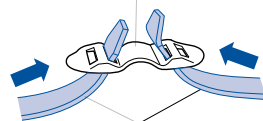

Top straps / Sangles supérieures / Correas superiores / Correas superiores

2b

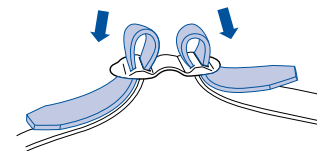

3b

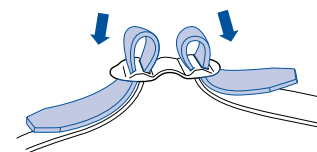

Mirage Swift™ II

NASAL PILLOWS SYSTEM

Thank you for choosing ResMed's Mirage Swift II Nasal Pillows System. The nasal pillows system is light, flexible and quiet. It is designed to minimize contact with your face, thus ensuring that you feel comfortable during therapy. This user guide provides you with the information you need for the correct use of your system.

Intended Use

The Mirage Swift II is intended for multipatient use by adult patients (>66 lb/30 kg) prescribed continuous positive airway pressure or bilevel therapy for use in home, hospitals or clinics.

Note: *The Mirage Swift II is not compatible for use with ResMed AutoSet CS™ 2 and VPAP™ Adapt SV devices.*



CAUTION

In the USA, federal law restricts this device to sale by, or on the order of, a physician.

Medical Information

Note: *The Mirage Swift II does not contain latex, PVC, or DEHP materials. If you have ANY reaction to any part of the system, discontinue use and consult your sleep therapist.*



WARNINGS AND CAUTIONS

- This system should be used only with flow generators (CPAP or bilevel) recommended by your physician or respiratory therapist. It should not be used unless the flow generator is turned on and operating properly. The vent holes should never be blocked.

Explanation of the Warning: Flow generators are intended to be used with special interfaces with connectors which have vent holes (vent holes are

located on the frame—see section **A** on the illustrations sheet) or separate exhalation devices to allow continuous flow of air out of the interface. When the flow generator is turned on and functioning properly, new air from the flow generator flushes the exhaled air out through the attached exhalation port. However, when the flow generator is not operating (eg, power failure), not enough fresh air will be provided through the system, and exhaled air may be rebreathed. In this situation, remove the Mirage Swift II immediately.

- The exhaust vent flow is lower at lower system pressures (see section “Technical Specifications” for Pressure-Flow Curve details). If the system pressure during expiration is too low, there may not be enough exhaust vent flow to completely flush the air delivery hose of exhaled air before the start of the next inspiration.
- Discontinue using the Mirage Swift II if you frequently experience nasal irritation, and consult your physician.
- The Mirage Swift II must be cleaned and disinfected/sterilized if it is used between patients. See section “Reprocessing the Mirage Swift II between Patients” for details.
- Do not modify the components of this system. Intentional modification of any of the components may cause injury or reduce therapy.
- If oxygen is used with the flow generator, the oxygen flow must be turned off when the flow generator is not operating.

Explanation of the Warning: When the flow generator is not in operation, and the oxygen flow is left on, oxygen delivered into the ventilator tubing may accumulate within the flow generator enclosure. Oxygen accumulated in the flow generator enclosure will create a risk of fire. This warning applies to most types of flow generators.

- Please refrain from smoking while oxygen is in use.
- Using a mask may cause tooth, gum or jaw soreness or aggravate an existing dental condition. If symptoms occur, consult your physician or dentist.

Note: *At a fixed flow rate of supplemental oxygen flow, the inhaled oxygen concentration will vary, depending on the pressure settings, patient breathing pattern, interface selection and the leak rate.*

Parts of the Mirage Swift II

See section **A** on the illustrations sheet.

Fitting the Mirage Swift II

Note: Refer to your flow generator manual for details on settings and operational information.

See section **B** on the illustrations sheet.

- 1 Put the headgear on your head and place the nasal pillows below your nose. Make sure the top strap passes over the top of your head. **Make sure the ResMed logo on the pillow sleeve faces outward; away from your face (B-1).**
- 2 Insert the nasal pillows into your nostrils. Gently tighten the headgear straps; first the back straps (**B-2a**) and then the top straps (**B-2b**). Alternate the adjustment of each set of straps, so that the headgear panels rest between the eye and the ear. The pillow sleeve should rest comfortably above your upper lip.
- 3 Adjust the angle of the nasal pillows. To do this, rotate the pillow sleeve assembly forward or backward so that the nasal pillows sit comfortably inside your nostrils (**B-3**).
- 4 Tube Retainer (optional).
Use the tube retainer if you prefer to have the short tube assembly secured to the headgear in the up position (**B-4**).
- 5 The short tube assembly can be attached in four different ways (**B-5**).
Note: *The short tube assembly and cap can be connected to either side of the pillow sleeve. See “Disassembling for Cleaning” and “Reassembling the Mirage Swift II” for instructions on how to remove and attach the short tube assembly and cap.*
- 6 Connect one end of the main air tubing to your flow generator and the other end to the swivel. Turn your flow generator on.

Notes:

- **Flow generator mask setting:** *If available, select “Swift”; otherwise select “Mirage” as the mask option when using the Mirage Swift II with ResMed flow generators that have mask setting options.*
- **SmartStop feature:** *This feature may not operate effectively when using the Mirage Swift II with some ResMed flow generators that have the SmartStop feature. This is particularly relevant when using the small size pillow sleeve.*

If you feel air leaks, readjust the angle of the nasal pillows to get a better seal. You may need to readjust the headgear straps. Do not overtighten the headgear straps.

If you are unable to resolve any leaks you may need an alternative pillow sleeve size.

- 7 Take time to adjust the following to achieve a secure and comfortable fit:
- headgear straps
 - angle of the pillow sleeve assembly
 - position of the short tube assembly.

Removing the Mirage Swift II

To remove the Mirage Swift II, pull the pillow sleeve assembly away from your nose and lift the headgear off your head. You do not need to loosen the headgear straps.

Disassembling for Cleaning

See section C on the illustrations sheet.

Before disassembling the Mirage Swift II, disconnect the flow generator tubing. To do this, hold the swivel and pull it away from the flow generator tubing.



CAUTION

Do not pull on the short tube or the flow generator tubing as they may get damaged.

- To disassemble the Mirage Swift II for **daily** cleaning, follow steps 1–3.
 - To disassemble the Mirage Swift II for **weekly** cleaning, follow steps 1–5.
- 1 Detach the short tube assembly. To do this, hold the elbow and pull it away from the seal ring (C-1).
Note: *The short tube assembly cannot be taken apart.*
 - 2 Remove the cap by pulling it away from the seal ring (C-2).
 - 3 Detach the headgear ring from the pillow sleeve assembly. Simply pull the headgear rings from the ends of the frame (C-3).
 - 4 Disassemble the pillow sleeve assembly. To do this, slide off the clip (C-4a) and then peel the pillow sleeve off the frame (C-4b).
Note: *When sliding the clip, hold it at one end, not in the middle.*
 - 5 The seal rings do not need to be removed from the headgear (C-5).

Cleaning the Mirage Swift II in the Home

Notes:

- *Wash your hands before cleaning the mask.*
- *Wash the headgear before first time use, as the dye may run. It is important to always handwash the headgear.*
- *The headgear may be washed without being disassembled.*

Daily

Handwash the pillow sleeve assembly, short tube assembly and cap in warm (approx. 86°F/30°C) water using mild soap or detergent. Rinse the components well and allow them to air dry out of direct sunlight and heat.

The system components have been tested using Dove™ Unscented beauty bar.

Note: Ensure that the vent holes are not blocked. Use a soft bristle brush to clean the vent.

Weekly

Handwash the headgear, tube retainer and all components in warm, (approx. 86°F/30°C) water using mild soap or detergent. Rinse the components well and allow them to air dry out of direct sunlight and heat.



CAUTION

- Do not use solutions containing bleach, chlorine, alcohol, aromatics, moisturizers, antibacterial agents, or scented oils to clean any part of the system or air tubing. These solutions may cause damage and reduce the life of the product.
- Exposing any part of the system or tubing to direct sunlight or heat may cause deterioration.
- If any change in performance or visible deterioration of a component is apparent (cracking, crazing, tears etc), the component should be discarded and replaced.

Reprocessing the Mirage Swift II between Patients

The Nasal Pillows System should be reprocessed when used between patients. Cleaning, disinfection and sterilization instructions are available from the ResMed website, www.resmed.com/masks/sterilization/americas.

If you do not have Internet access, please contact your ResMed representative.

Reassembling the Mirage Swift II



CAUTION

Components of the Mirage Swift II pillow sleeve assembly (pillow sleeve, frame and clip—see section A on the illustration sheet) are not compatible for use with Mirage Swift components. Combining these components from the two systems may result in rebreathing of exhaled air.

See section **D** on the illustrations sheet.

- 1 Make sure both seal rings are properly fitted to the headgear rings (**D-1**).
- 2 Assemble the pillow sleeve assembly. To do this:
 - a Wrap the pillow sleeve around the frame. Then insert the pillow sleeve edges into the groove of the frame (**D-2a**).
 - b Hold the clip at one end and then slide it onto the frame to secure the pillow sleeve in place (**D-2b**).

Note: *If the clip does not slide easily, check that the pillow sleeve edge is fitted flush to the groove of the frame.*

- 3 Attach the headgear ring to the pillow sleeve assembly. To do this, firmly push the headgear rings onto the ends of the frame (**D-3**). When attaching the pillow sleeve assembly make sure:
 - the headgear panels are facing out
 - the nasal pillows are pointing upwards
 - the ResMed logo faces out—away from the headgear.

Make sure the pillow sleeve assembly is properly fitted to the headgear before going on to the next step.

- 4 Attach the short tube assembly to your preferred side of the pillow sleeve assembly. To do this, push the elbow into the seal ring until it clicks into place (**D-4**).
- 5 Insert the cap into the other seal ring until it clicks into place (**D-5**).
- 6 The assembled system should look like this (**D-6**). Make sure the ResMed logo on the pillow sleeve faces out—away from the headgear.

Additional Information

Reassembling the Headgear

See section **E** on the illustrations sheet.

If taken apart, the headgear has four parts:

A: Left strap; B: Right strap; C: Back buckle; D: Top buckle.

- 1 Lay out the four parts of the headgear as shown in (**E-1**). The panels must face up.

Note: *Before threading the straps, make sure that the buckles are positioned as shown in (**E-2**) and (**E-3**).*

- 2 Thread the back straps through the back buckle (part C) as shown in (**E-2a**) and (**E-2b**).
- 3 Thread the top straps through the top buckle (part D) as shown in (**E-3a**) and (**E-3b**).

Disposal

The Mirage Swift II Nasal Pillows System does not contain any hazardous substances and may be disposed of with your normal household refuse.

Technical Specifications

Pressure–Flow Curve

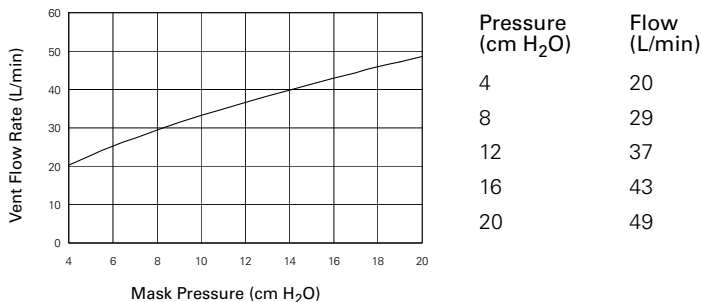

Note: As a result of manufacturing variations, the vent flow may vary from the values listed in the table.

Dead Space Information

Dead space is the empty volume of the pillow sleeve and short tube assembly up to the swivel.

The dead space of the Mirage Swift II for all pillow sleeve sizes is 91 mL.

Standards

CE designation in accordance with EC directive 93/42/EEC, class IIa.
EN ISO 14971, ISO 5356-1, ISO 10993-1 and EN ISO 17510-2.

Therapy Pressure

4 to 20 cm H₂O

Resistance

Drop in measured pressure between the swivel and pillow sleeve (average for three pillow sleeve sizes):

at 50 L/min: 0.4 cm H₂O

at 100 L/min: 1.6 cm H₂O

Symbols

System and Packaging



Caution, consult accompanying documents



Lot number



Part number



European Authorised Representative



Manufacturer

User Guide



Indicates a Warning or Caution and alerts you to a possible injury or explains special measures for the safe and effective use of the device.

Ordering Information

Part No. Item

System

60512 Mirage Swift II Nasal Pillow System - AMER

Replacement Parts

60541 Pillow sleeve, *Small* (1 pk.)

60542 Pillow sleeve, *Medium* (1 pk.)

60543 Pillow sleeve, *Large* (1 pk.)

60523 Headgear buckle (4 pk.)

60524 Seal ring (10 pk.)

60525 Cap (1 pk.)

60526 Headgear (1 pk.)

60536 Frame with Clip and Cap (1 pk.)

60528 Short tube assembly (1 pk.)

60529 Short tube assembly (10 pk.)

60530 Tube retainer (3 pk.)

60537 Frame System with Pillow sleeve (excluding headgear), *Small*

60538 Frame System with Pillow sleeve (excluding headgear), *Medium*

60539 Frame System with Pillow sleeve (excluding headgear), *Large*

Part No. Item

60540 Clip (1 pk.)

Accessories

61121 Distal pressure port (1 pk.)

61124 Distal pressure port (10 pk.)

60549 Main pressure port (1 pk.)

60550 Main pressure port (10 pk.)

Limited Warranty

ResMed warrants that your ResMed system, including its components—frame, pillow sleeve, headgear, tubing and other accessories (“Product”)—shall be free from defects in material and workmanship for a period of ninety (90) days from the date of purchase by the initial consumer.

For further details refer to the Warranty.



Manufacturer:

ResMed Ltd 1 Elizabeth Macarthur Drive Bella Vista NSW 2153 Australia

Distributed by:

ResMed Corp 9001 Spectrum Center Boulevard San Diego CA 92123 USA

ResMed (UK) Ltd 96 Milton Park Abingdon Oxfordshire OX14 4RY UK

See www.resmed.com for other ResMed locations worldwide.



For patent information, see www.resmed.com/ip.

Mirage, Mirage Swift, AutoSet CS 2 and VPAP Adapt SV are trademarks of ResMed Ltd and Mirage, Swift, AutoSet CS and VPAP are registered in U.S. Patent and Trademark Office.

Dove is a trademark of Unilever.

© 2012 ResMed Ltd.

60893/3 2012-06

Mirage Swift II

User

AMER - ENG



60893