

1 Replacing the Filter

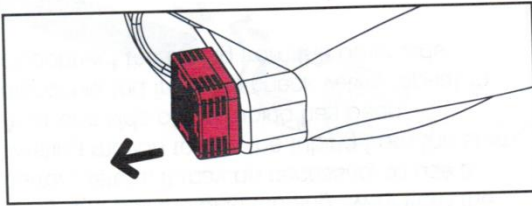

Step 1: Remove old filter

Remove the old filter from the SoClean 2 Go sanitizing bag by pulling the filter out of its pocket. It may then be discarded.

Step 2: Prepare the new filter.

Remove the O-ring and set aside. Completely remove all protective plastic and tape from the new filter. You may see some black particles on the filter or on your hands. This is normal from settling during shipping and can be wiped off. Replace the O-ring back on the cartridge filter, approximately 1/3 up from the bottom.

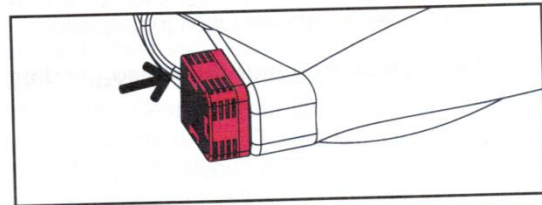

Step 3: Install new filter

Insert the new filter into the SoClean 2 Go filter pocket.

Now see **Replacing the Check Valve**

2 Replacing the Check Valve

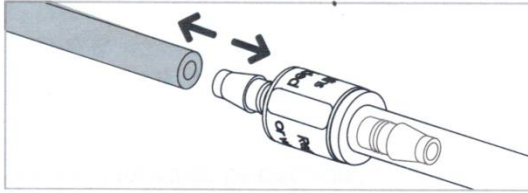

Step 1: Removal of your current check valve

Grasp the barrel of your current check valve firmly and pull the black tubing away from the barrel system. It may be necessary to use a twisting motion to free the tubing from the stem. After one side of the tubing has been disconnected from the check valve, repeat to disconnect the tubing from the other side.

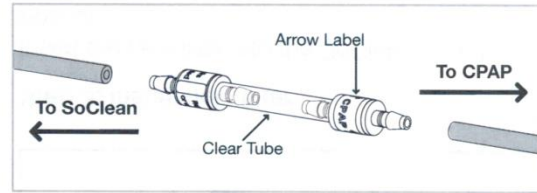

Step 2: Positioning your new check valve

The direction of your new check valve is critical. Your SoClean 2 Go will not work if it is installed facing the wrong direction. The end of your new check valve has a label with 2 arrows that should be pointing away from your SoClean 2 Go and toward to your CPAP machine.

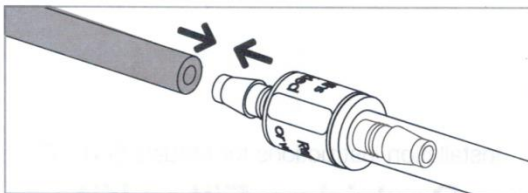

Step 3: Installing your new check valve

With your check valve facing the correct direction, grasp the barrel and insert the stem as far as possible into the end of the tubing. The tubing should be nearly touching the barrel of the check valve. A thin film of dish soap on the stem can be used to help it slide on easier. Repeat for the remaining side of the check valve.

3 Using the Acrylic Sleeve

Separate the mask hose from the main hose, and thread the acrylic sleeve onto the end of the main hose. Reattach your face mask hose. Place your mask into the SoClean 2 Go sanitizing bag. Align the acrylic sleeve with the opening of the bag and then tighten the bag snug around the acrylic sleeve for a tighter seal.