

# Mirage Activa™

NASAL MASK

## Fitting Guide



**1**

- With one headgear clip released from mask, place mask cushion on nose and pull headgear over the head.
- Connect free headgear clip to mask frame.



**2**

- Adjust upper and lower headgear straps until mask cushion sits loosely on face, with forehead pads lightly touching forehead.



**3**

- If forehead pads do not touch forehead, adjust forehead support by depressing tab.
- To move tab up, tilt pads forward. To move tab down, tilt pads backward.



**4**

- Connect one end of main air tubing to flow generator and other end to mask swivel.
- Connect mask elbow to mask frame—push firmly until it clicks into place.



**5**

- Turn flow generator on and allow cushion to inflate. If there are air leaks around cushion, lift mask slightly off face and reposition.
- You may need to readjust straps and/or forehead support. Do not overtighten straps—ensure that ActiveCell chamber of mask cushion is moderately and evenly inflated.
- To remove mask, squeeze headgear clips and pull mask and headgear away from head.

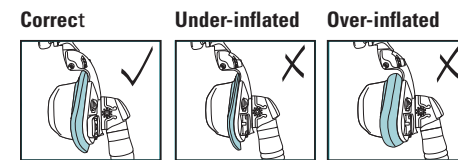

# Mirage Activa™

NASAL MASK

### The ultimate in seal and comfort

The Mirage Activa™ incorporates ActiveCell™ Technology — ResMed's exclusive, auto-stabilizing cushion technology. ActiveCell Technology combines the proven comfort and seal of Mirage™ cushion technology with an inflatable chamber that expands and contracts during therapy.

### Automatically adapts and seals

ActiveCell Technology allows the mask to automatically adapt and respond to changes that occur during sleep, such as changes in body position.

### Savings in time and cost

The mask's innovative design increases efficiency, reduces overall cost, and improves compliance.

**Flexible forehead pads'** one-piece design distributes pressure evenly and conforms to the contour of the patient's forehead

**Adjustable forehead support** offers four positions for better seal and stability

**Convenient cushion clip** is preassembled with cushion, making it easy to attach and detach from mask frame

**One-snap elbow** with 360° rotation allows quick and easy removal of the air tube while the mask is still on the face

**Quick-release headgear clips** allow mask to be removed without resetting the headgear for optimal convenience

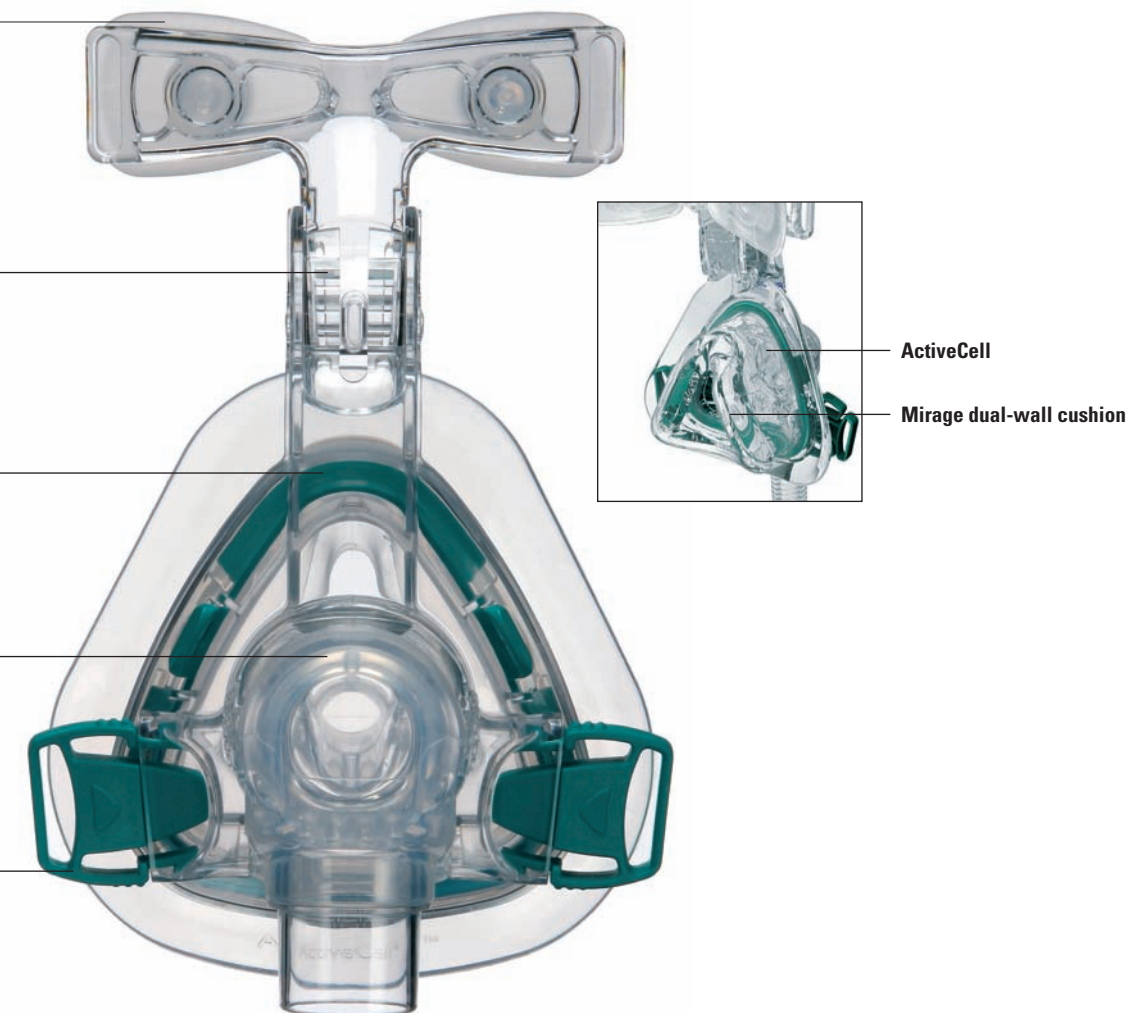

**TECHNOLOGY HIGHLIGHT—  
ACTIVECELL TECHNOLOGY**

- The ActiveCell is an inflatable chamber that expands and contracts during therapy, providing a unique, active seal and a dynamic defense against mask leak.
- ActiveCell Technology minimizes dependence on headgear strap tension.
- The ActiveCell helps prevent leak while minimizing pressure on the face.
- The ActiveCell functions as an independent suspension, keeping the cushion in place even when various forces pull or push the mask frame in different directions.

**ActiveCell**

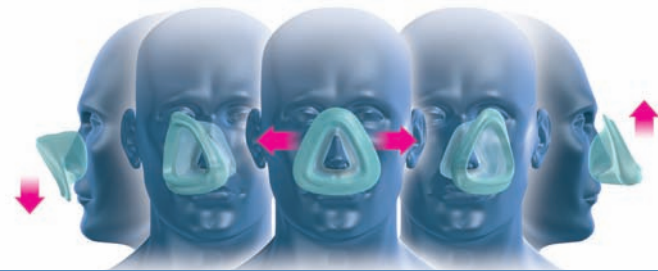
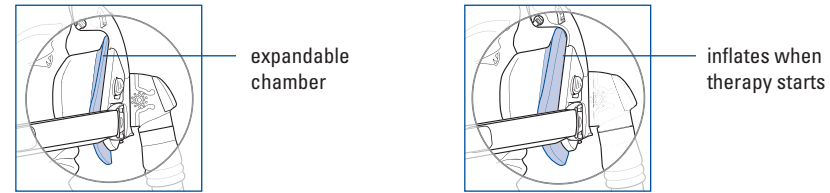

**PATIENT BENEFITS**

- More choice of head and body positions and fewer leak-induced arousals may lead to better quality sleep.
- Reduced strap tension and minimized leak offers increased comfort.
- Set-and-forget convenience eliminates the need to continually adjust the headgear.
- Eye and skin irritation are significantly reduced.

**PROFESSIONAL BENEFITS**

- Mirage Activa can dramatically reduce mask fitting time.
- First-time fit is likely to be achieved more easily with Mirage Activa.
- Improved comfort and therapy acceptance minimize callbacks and returns.
- Increased comfort and leak control can help optimize patient compliance.

**PRODUCT CODES**

**Mirage Activa Nasal Mask**

North and Latin America	
Standard	60100
Large	60101
Shallow	60102

**REIMBURSEMENT CODES**

HCPCS	Code Descriptor
A7034	Nasal mask used with positive airway pressure device, 1 per 3 months
A7032	Replacement cushion for nasal mask, 2 per month
A7035	Headgear used with positive airway pressure device, 1 per 6 months

# Mirage Activa™

## NASAL MASK

### Components Card

**Complete system**

Standard	<b>60100</b>
Large	<b>60101</b>
Shallow	<b>60102</b>

**Headgear**

Small	<b>16118</b>
Standard	<b>60114</b>
Large	<b>16119</b>

**Frame system\***

(no headgear)

Standard	<b>60111</b>
Large	<b>60112</b>
Shallow	<b>60113</b>

**Frame assembly\***

(no headgear, no cushion)

Standard	<b>60144</b>
----------	--------------

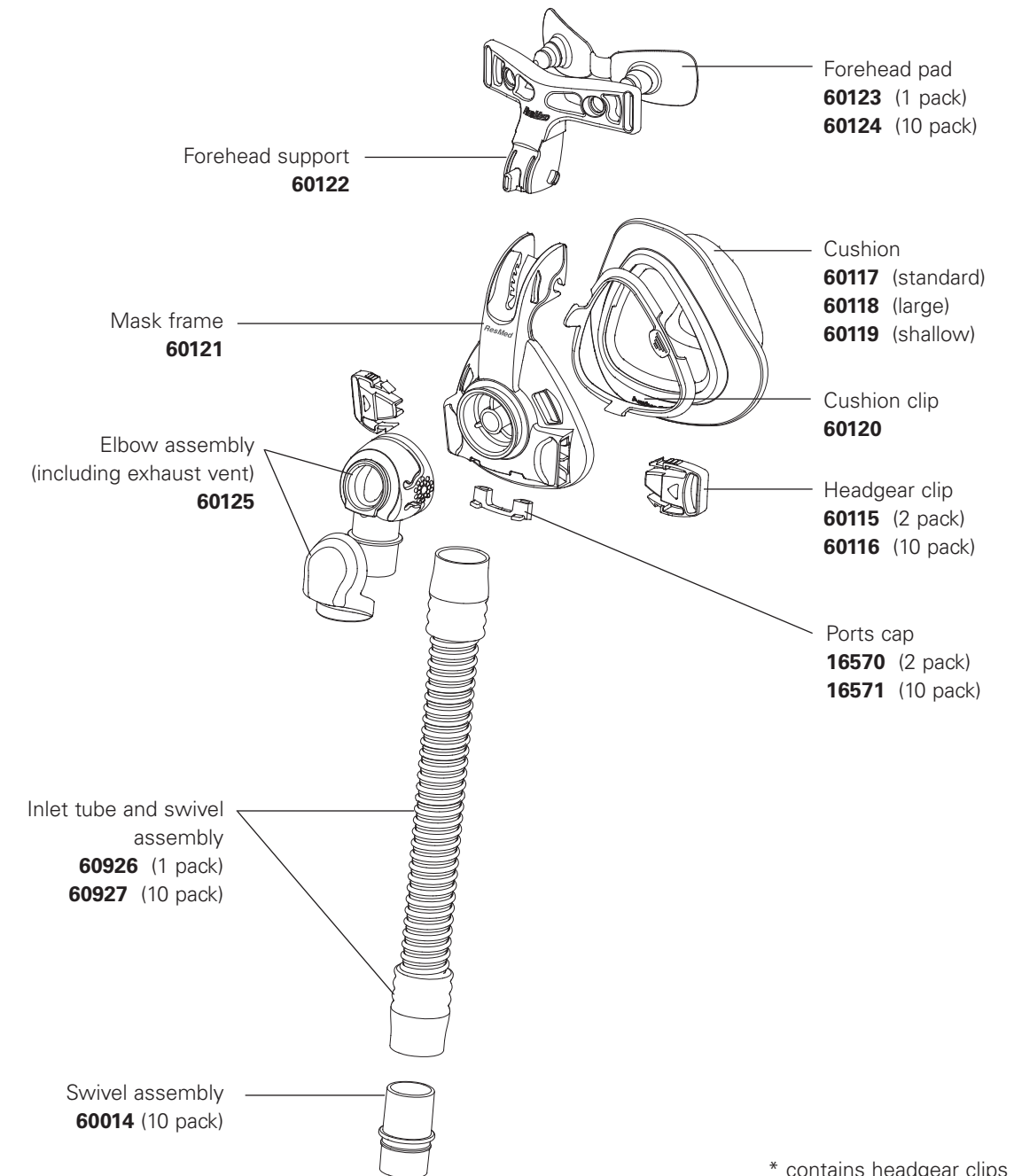

\* contains headgear clips