



Buy AirTouch N30i at [RespShop.com](https://www.RespShop.com). [Click Here](#)



AirTouch™ **N30i**



## How to fit the AirTouch N30i



1 Pull the frame and headgear over the head so the elbow sits on top and the headgear is positioned behind the head.



2 Place the cushion under the nose. Tighten or loosen the headgear until the cushion fits comfortably.



3 Squeeze the side buttons on the elbow and detach it from the frame.

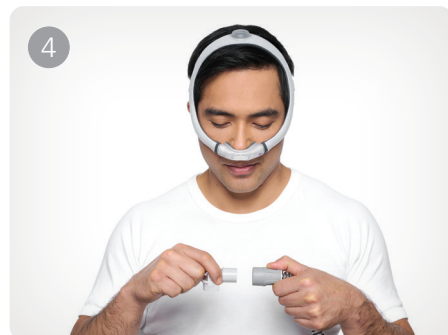

4 Connect the air tubing from the device to the elbow.



5 Reattach the elbow to the frame. The mask is now ready to use.



Wear longer hair over the top of the headgear for the best fit.

Refer to the user guide for further instructions and complete labeling information, including indications, contraindications, warnings and precautions.

## Experience the ResMed AirTouch N30i today.

With a flexible, fabric-wrapped frame and our innovative ComfiSoft™ nasal cushion, ResMed's new AirTouch N30i nasal mask is designed to bring you a more natural sleeping experience. Brought to you by the sleep apnea brand most trusted by sleep physicians.<sup>2</sup>



Scan the QR code or contact your ResMed sales representative to get going.



<sup>1</sup> ResMed AirTouch N30i demonstrated a 97.2% fit range based on acceptable seal and comfort after 90 days of use. (refer to RMO\_WSN\_73).

<sup>2</sup> ResMed study of board certified sleep physicians in the U.S. Study conducted August 12–September 6, 2022. n=200

Distributed by ResMed Corp., 9001 Spectrum Center Blvd., San Diego, CA 92123 USA. AirTouch, ComfiSoft, and QuietAir are trademarks of the ResMed family of companies. For patent and other intellectual property information, see [ResMed.com/ip](https://www.ResMed.com/ip). © 2024 ResMed. 10114156/1 2024-09

[ResMed.com/AirTouchN30i](https://www.ResMed.com/AirTouchN30i)



# Our lightest touch yet.

The ResMed AirTouch™ N30i



## Live life in high Res



AirTouch™  
**N30i**



# Meet the ResMed AirTouch™ N30i

Introduce your patients to an exceptionally comfortable tube-up nasal mask: the ResMed AirTouch™ N30i. The brand-new ComfiSoft™ cushion combines the reliable seal and durability of silicone with the natural comfort only fabric can bring. Both the cushion and the flexible SpringFit™ frame automatically contour to the shape of the face and nose, and are designed to gently make compliance so much more achievable.



**Fabric-wrapped SpringFit™ frame**  
The self-adjusting silicone tubular frame is fully wrapped in super soft, breathable, moisture-wicking fabric that's light, gentle on the face and keeps skin cool.

Available in two sizes and designed to easily adjust to different facial profiles and head shapes for an accurate fit the first time.

**Fabric and silicone seal technology**  
Designed to maximize comfort without compromising seal performance.

**ComfiSoft™ cushion**  
Fabric fused with silicone creates a cushion seal that's soft, breathable and moisture-wicking.

**Nasal cradle design**  
Available in three sizes to cover 97% fit range.<sup>1</sup> The curved design contours to the patient's nose for a secure and comfortable seal all night.



**Quick-release elbow**  
Allows patients to easily disconnect and reconnect mask from tubing.

**Tube-up mask design**  
Takes air tubing out of the way to give patients the freedom to sleep in any position.

**Easy-to-adjust headgear**  
Shaped to sit comfortably at the back of the head ① with side tabs ② ③ designed to get the fit just right.

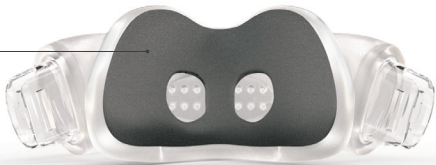

Cushion back

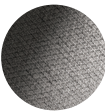

**Cushion Innovation**  
Soft fabric covers nearly all of the nasal area for ultimate skin comfort.



Cushion front

**QuietAir™ diffused vent**  
Designed to be quieter than a whisper while minimizing breeze for both patients and bed partners.

**Complete mask system**  
62300  
62301  
62310  
62311  
62312  
62313  
62314  
62315

Nasal cradle cushion (SW, M, L)

Elbow

Headgear

Frame (STD, SML)

Frame system (62316, 62317, 62318, 62319, 62320, 62321)

## AirTouch™ N30i

**Complete mask system**  
(includes mask frame, nasal cushion and headgear)

Product name	Model number
AirTouch N30i STD STPK AMER	62300
AirTouch N30i SML STPK AMER	62301
AirTouch N30i SYS – SW/STD	62310
AirTouch N30i SYS – M/STD	62311
AirTouch N30i SYS – L/STD	62312
AirTouch N30i SYS – SW/SML	62313
AirTouch N30i SYS – M/SML	62314
AirTouch N30i SYS – L/SML	62315

**Nasal cushion**

Product name	Model number
AirTouch N30i Cushion – SW	62330
AirTouch N30i Cushion – M	62331
AirTouch N30i Cushion – L	62332

**Frame system** (includes mask frame and nasal cushion)

Product name	Model number
AirTouch N30i Frame SYS – SW/STD	62316
AirTouch N30i Frame SYS – M/STD	62317
AirTouch N30i Frame SYS – L/STD	62318
AirTouch N30i Frame SYS – SW/SML	62319
AirTouch N30i Frame SYS – M/SML	62320
AirTouch N30i Frame SYS – L/SML	62321

**Headgear**

Product name	Model number
N30i/P30i Headgear	63814

Live life in high Res

